



HIGHWAYS ADVISORY COMMITTEE

23 October 2018

Subject Heading:

SCH353 Mawney Road, south of Eastern Avenue, part of the RO2B controlled parking zone – proposals to review existing parking provision

CMT Lead:

Dipti Patel

Report Author and contact details:

John-Paul Micallef
01708 432385
Engineering Officer
John-Paul.Micallef@havering.gov.uk

Policy context:

Traffic & Parking Control

Financial summary:

The estimated cost of implementation is £0.004m and will be met from the LIP allocation 2018/2019 - A2904.

The subject matter of this report deals with the following Council Objectives

Communities making Havering	[x]
Places making Havering	[x]
Opportunities making Havering	[x]
Connections making Havering	[x]

SUMMARY

The Schemes section of Havering Council are committed to solving Parking issues within the Borough, and will maximise 'on-street' parking for Residents where possible, with the emphasis on safety and maintaining vehicular access.

This report outlines the responses received to the detailed parking consultations undertaken in the Mawney Road area and recommends a further course of action.

Ward:

Brooklands Ward

RECOMMENDATIONS

- 1) That the Committee having considered the report and the representations made recommends to the Cabinet Member for Environment, following consultation with the Leader of the Council, that:
 - a. The proposals to introduce a residents parking scheme, operational Monday – Friday, 8.30am – 6.30pm inclusive, in Mawney Road, south of eastern avenue as amended to this report as **Appendix A** to be introduced;
 - b. Members note that additional Double Yellow Lines are to be implemented in Mawney Road to assist traffic flow.

- 2) Members note that the estimated cost of the fully implemented proposals, including all physical measures and advertising costs, should a scheme be implemented is £0.004m and will be met from the LIP 2018/2019 funding allocation – A2904.

REPORT DETAIL

1.0 Background

- 1.1 Following reports from local residents regarding inconsistencies between the times of operations and legality of the signs and lines within the area in early 2017, this Committee agreed to formally consult the area in February 2018 to identify and deal with parking related issues and gauge the views of local residents on the current parking situation in their road.
- 1.2 Due to the inconsistent signage, the committee agreed to formally consult on a resident's parking scheme, operational Monday – Saturday, 8.30am – 6.30pm.
- 1.3 A detailed consultation was undertaken in May 2018, and the results were distributed to Ward Councillors on 5th July 2018. A total of 379 properties were consulted with 9 responses received giving just under 2.4% response rate. Out of the 9 responses, 8 were against the proposals and wanted the days of operations changed to Monday – Friday. One resident stated that the bay outside 112 Mawney Road would make it hard for them to see oncoming traffic when turning out of their driveway. 1 resident requested for Marks Road to be included into the RO2B zone instead of the ROW zone. The original consulted plan is appended to this report as **Appendix B**.
- 1.4 Following detailed discussions with ward councillors and taking full consideration of the consultation responses officers consider that the Mawney Road scheme should operate between Monday – Friday, not Monday – Saturday (Originally Proposed). Furthermore, it was also agreed to remove the bay proposed outside 112 Mawney Road due to sight line issues for a resident within the immediate area.

2.0 Responses received

- 2.1 The responses received from the Statutory Consultation are appended at **Appendix C**. All respondents are requested to see the council's recommendations page in response to their comments.

3.0 Staff Comment

- 3.1 Following the Statutory Consultation and the objections received, the Schemes section would recommend that the scheme goes in as amended in the recommendations.
- 3.2 The Ward Councillors were presented with the results on the 5th July 2018, and responded on the 7th July 2018. The Ward Councillors gave their full

support for the scheme to progress as amended. The new plans are now appended to this report as **Appendix A**.

IMPLICATIONS AND RISKS

Financial implications and risks:

This report is asking HAC to recommend that this scheme is progressed to be implemented following the Statutory Consultation, for the Mawney Road area, as laid out in **Appendix A**.

The estimated cost of implementing the proposals, including physical measures, advertising and making the Traffic Management Orders is £0.004m, and will be met from the LIP 2018/2019 funding allocation – A2904.

The costs shown are an estimate of the full costs to implement a scheme should it be ultimately implemented. It should be noted that further decisions are to be made following a full report to the Committee and with the Cabinet Member approval process being completed where a scheme is recommended for implementation.

This is a standard project for Environment and there is no expectation that the works cannot be contained within the cost estimate. There is an element of contingency built into the financial estimate. In unlikely event of an overspend, the balance would need to be contained within the overall Environment budget.

Legal implications and risks:

The Council's power to make an order creating a controlled parking zone is set out in Part IV of the Road Traffic Regulation Act 1984 ("RTRA 1984").

Before an Order is made, the Council should ensure that the statutory procedures set out in the Local Authorities Traffic Orders (Procedure) (England & Wales) Regulations 1996 (SI 1996/2489) are complied with. The Traffic Signs Regulations and General Directions 2002 govern road traffic signs and road markings.

Section 122 RTRA 1984 imposes a general duty on local authorities when exercising functions under the RTRA. It provides, insofar as is material, to secure the expeditious, convenient and safe movement of vehicular and other traffic (including pedestrians) and the provision of suitable and adequate parking facilities on and off the highway. This statutory duty must be balanced with any concerns received over the implementation of the proposals.

In considering any responses received during consultation, the Council must ensure that full consideration of all representations is given including those which do not accord with the officer's recommendation. The Council must be satisfied that any objections to the proposals were taken into account.

In considering any consultation responses, the Council must balance the concerns of any objectors with the statutory duty under section 122 RTRA 1984.

Human Resources implications and risks:

It is anticipated that the enforcement activities required for these proposals can be met from within current staff resources.

Equalities implications and risks:

Havering has a diverse community made up of many different groups and individuals. The council values diversity and believes it essential to understand and include the different contributions, perspectives and experience that people from different backgrounds bring.

The Public Sector Equality Duty (PSED) under section 149 of the Equality Act 2010 requires the council, when exercising its functions, to have due regard to:

- (i) the need to eliminate discrimination, harassment, victimisation and any other conduct that is prohibited by or under the Equality Act 2010;
- (ii) the need to advance equality of opportunity between persons who share protected characteristics and those who do not, and;
- (iii) foster good relations between those who have protected characteristics and those who do not.

Note: 'Protected characteristics' are: age, sex, race, disability, sexual orientation, marriage and civil partnerships, religion or belief, pregnancy and maternity and gender reassignment.

The council demonstrates its commitment to the Equality Act in its decision-making processes, the provision, procurement and commissioning of its services, and employment practices concerning its workforce. In addition, the council is also committed to improving the quality of life and wellbeing of all Havering residents in respect of socio-economics and health determinants.

Parking restrictions in residential areas are often installed to improve road safety and accessibility for residents who may be affected by long-term non-residential parking.

Parking restrictions have the potential to displace parking to adjacent areas, which may be detrimental to others. However, the Council has a general duty under the Equality Act 2010 to ensure that its highway network is accessible to all. Where infrastructure is provided or substantially upgraded, reasonable adjustments should be made to improve access. In considering the impacts and making improvements for people with protected characteristics (mainly, but not limited to disabled people, children, young people and older people), this will assist the Council in meeting its duty under the act.

The proposal to install a Residents Parking Scheme and 'At Any Time' waiting restrictions will be publicly advertised and are subject to formal consultation.

Consultation responses will be carefully considered prior to a further course of action being recommended. There will be some visual impact from further signing and lining works.

Appendix A-

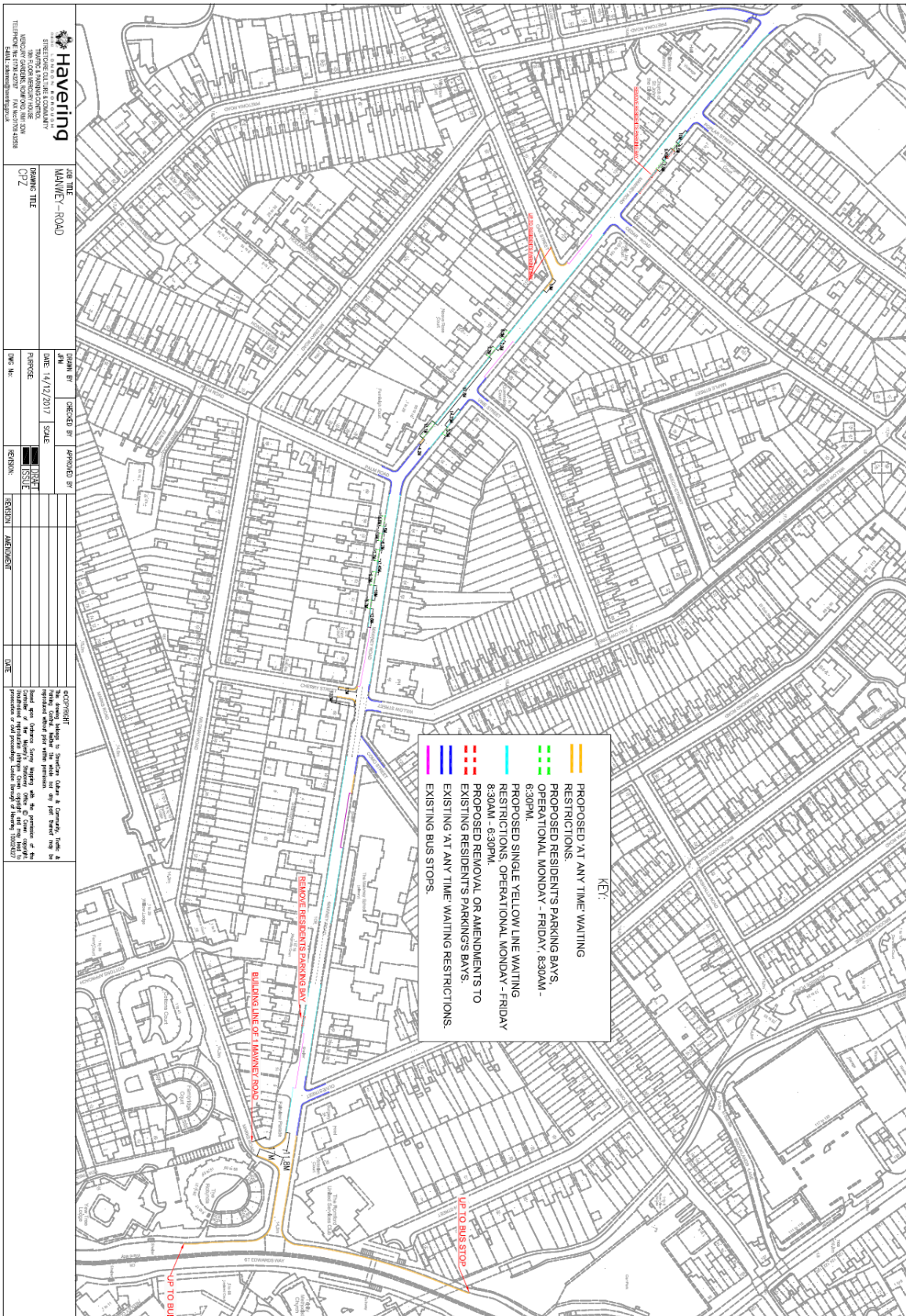

Havering
 STRATEGIC POLICE COMMUNITY
 TRAFFIC & PARKING CONTROL
 MEDICAL OFFICER, ROADWORKS DIVISION
 TILFORD ROAD, HAVERING, ESSEX, SSM16 5LW
 TEL: 0206 8556000 FAX: 0206 8556000

JOB TITLE
 MAWNEY ROAD
DRAWING TITLE
 072

DRAWN BY
 JIM
CHECKED BY
 SCALE
DATE
 14/12/2017

APPROVED BY
 [Signature]
REVISION
 [Table with 2 columns: REVISION, DATE]

DISCLAIMER
 The drawings herein are intended for the use of the client and are not to be used for any other purpose without the written consent of the client. The client is responsible for the accuracy of the information provided and for any consequences arising from the use of the drawings.

- KEY:**
- PROPOSED AT ANY TIME WAITING RESTRICTIONS.
 - PROPOSED RESIDENTS PARKING BAYS OPERATIONAL MONDAY - FRIDAY 8:30AM - 6:30PM.
 - PROPOSED SINGLE YELLOW LINE WAITING RESTRICTIONS OPERATIONAL MONDAY - FRIDAY 8:30AM - 6:30PM.
 - PROPOSED REMOVAL OR AMENDMENTS TO EXISTING RESIDENTS PARKING BAYS.
 - EXISTING AT ANY TIME WAITING RESTRICTIONS.
 - EXISTING BUS STOPS.

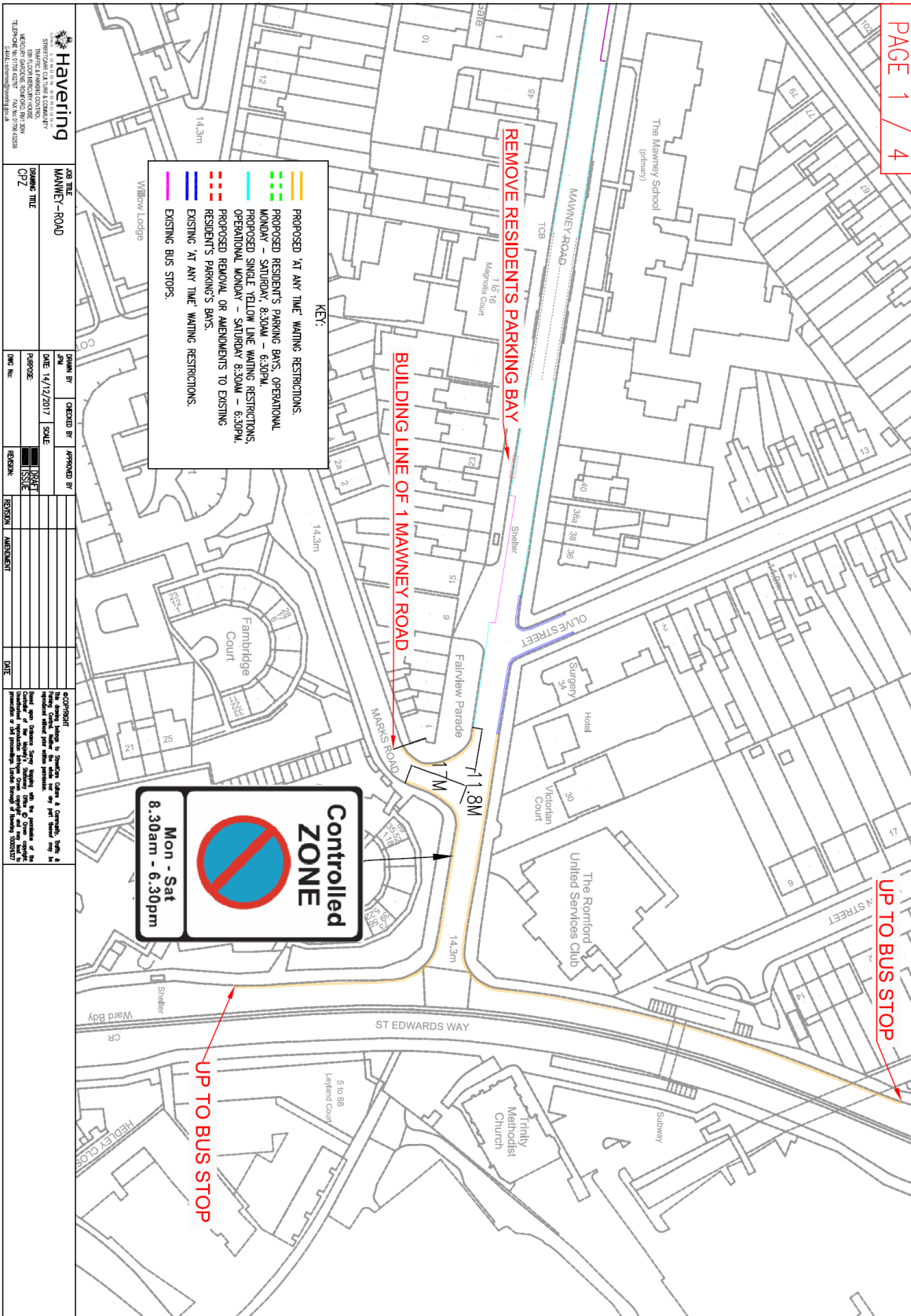

<p>Havering SURREY ROAD, HAVERING TEL: 0208 300 2000 WWW.HAVERING-ROADS.CO.UK</p>		<p>JOB TITLE MANNEV-ROAD</p>		<p>DRAWN BY [Name]</p>		<p>CHECKED BY [Name]</p>		<p>APPROVED BY [Name]</p>	
<p>DATE 14/12/2017</p>		<p>SCALE [Scale]</p>		<p>DATE [Date]</p>		<p>DATE [Date]</p>		<p>DATE [Date]</p>	
<p>PROJECT TITLE CPZ</p>		<p>PURPOSE [Purpose]</p>		<p>ISSUE [Issue]</p>		<p>REVISION [Revision]</p>		<p>AMENDMENT [Amendment]</p>	
<p>DATE [Date]</p>		<p>DATE [Date]</p>		<p>DATE [Date]</p>		<p>DATE [Date]</p>		<p>DATE [Date]</p>	

COPYRIGHT:
This drawing is the property of the Client and is not to be reproduced without their written permission.
The Client warrants that they have the right to use the drawing for the purposes of the project.
The Client warrants that they have the right to use the drawing for the purposes of the project.

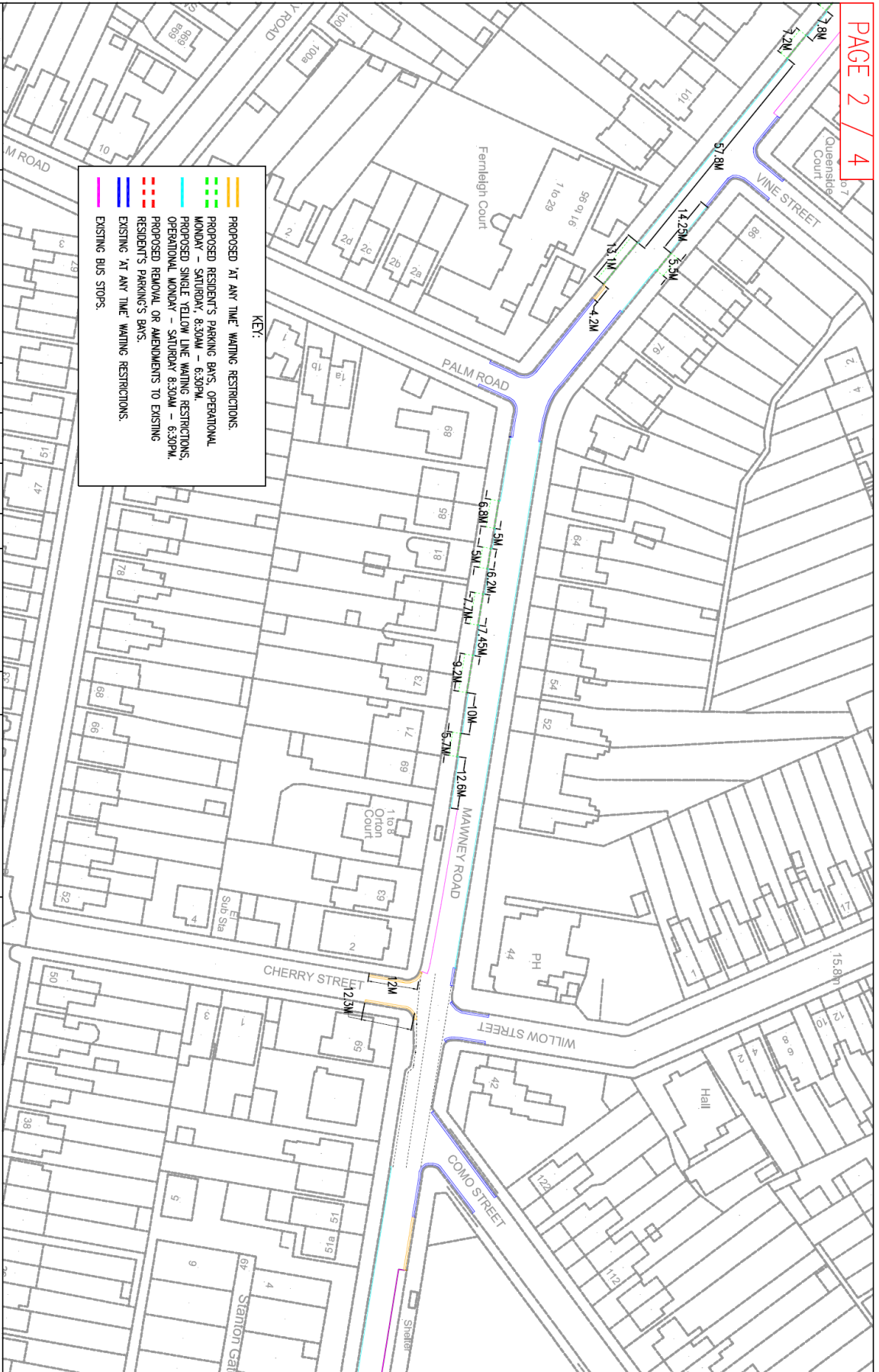

KEY:

- PROPOSED 'AT ANY TIME' WAITING RESTRICTIONS.
- PROPOSED RESIDENT'S PARKING BAYS, OPERATIONAL MONDAY - SATURDAY 8.30AM - 6.30PM.
- PROPOSED SINGLE YELLOW LINE WAITING RESTRICTIONS, OPERATIONAL MONDAY - SATURDAY 8.30AM - 6.30PM.
- PROPOSED REMOVAL OR AMENDMENTS TO EXISTING RESIDENT'S PARKING'S BAYS.
- EXISTING 'AT ANY TIME' WAITING RESTRICTIONS.
- EXISTING PARKING'S BAYS.
- EXISTING BUS STOPS.

<p>Haverling STRATEGIC PLANNING COMMUNITY THE FLOORBOARD HOUSE MEDWAY GARDEN, SOUTHDALE WAY, SW1 TELEPHONE: 01753 833333 EMAIL: info@haverling.co.uk</p>		<p>JOB TITLE MANNIEY-ROAD</p>		<p>DRAWN BY CPZ</p>	
<p>DATE 14/12/2017</p>		<p>CHECKED BY</p>		<p>APPROVED BY</p>	
<p>SCALE</p>		<p>REVISION</p>		<p>AMENDMENT</p>	
<p>DATE</p>		<p>REVISION</p>		<p>AMENDMENT</p>	
<p>COPYRIGHT This drawing is the property of Haverling Planning & Community, and is not to be reproduced without their written permission. Any use of this drawing without their written permission is strictly prohibited. Haverling Planning & Community, 10000127</p>					

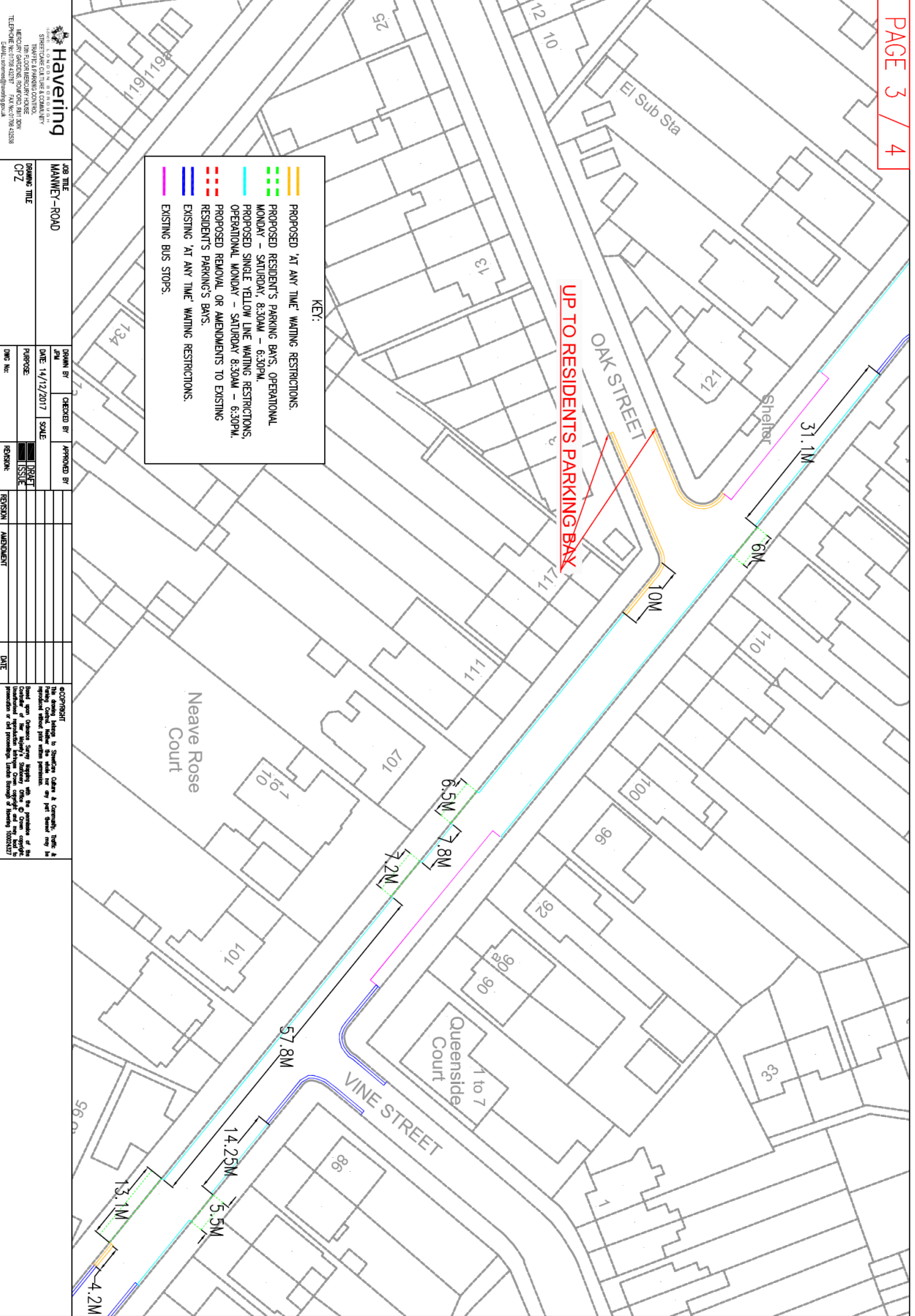

<p>Haverling SPECIALIST IN THE CONSTRUCTION OF THE COMMERCIAL AND INDUSTRIAL SECTORS</p> <p>100, GARDEN ROAD, TORONTO, ONT. M5V 1A7 TEL: 416-291-1111 FAX: 416-291-1112 E-MAIL: info@haverling.ca</p>		<p>JOB TITLE MANAGER-ROAD</p>	<p>DATE 14/12/2017</p>	<p>CHECKED BY [Signature]</p>	<p>APPROVED BY [Signature]</p>				
<p>DRAWING TITLE CPZ</p>	<p>SCALE AS SHOWN</p>	<p>REVISION</p> <table border="1"> <tr> <th>NO.</th> <th>DESCRIPTION</th> <th>DATE</th> </tr> <tr> <td> </td> <td> </td> <td> </td> </tr> </table>	NO.	DESCRIPTION	DATE				<p>EQUIPMENT</p> <p>This drawing is to be used for the construction of the project. It is the responsibility of the contractor to ensure that all equipment and materials are of the highest quality and are used in accordance with the specifications and standards of the project. The contractor is responsible for the safety of all personnel and the public during the construction process.</p>
NO.	DESCRIPTION	DATE							

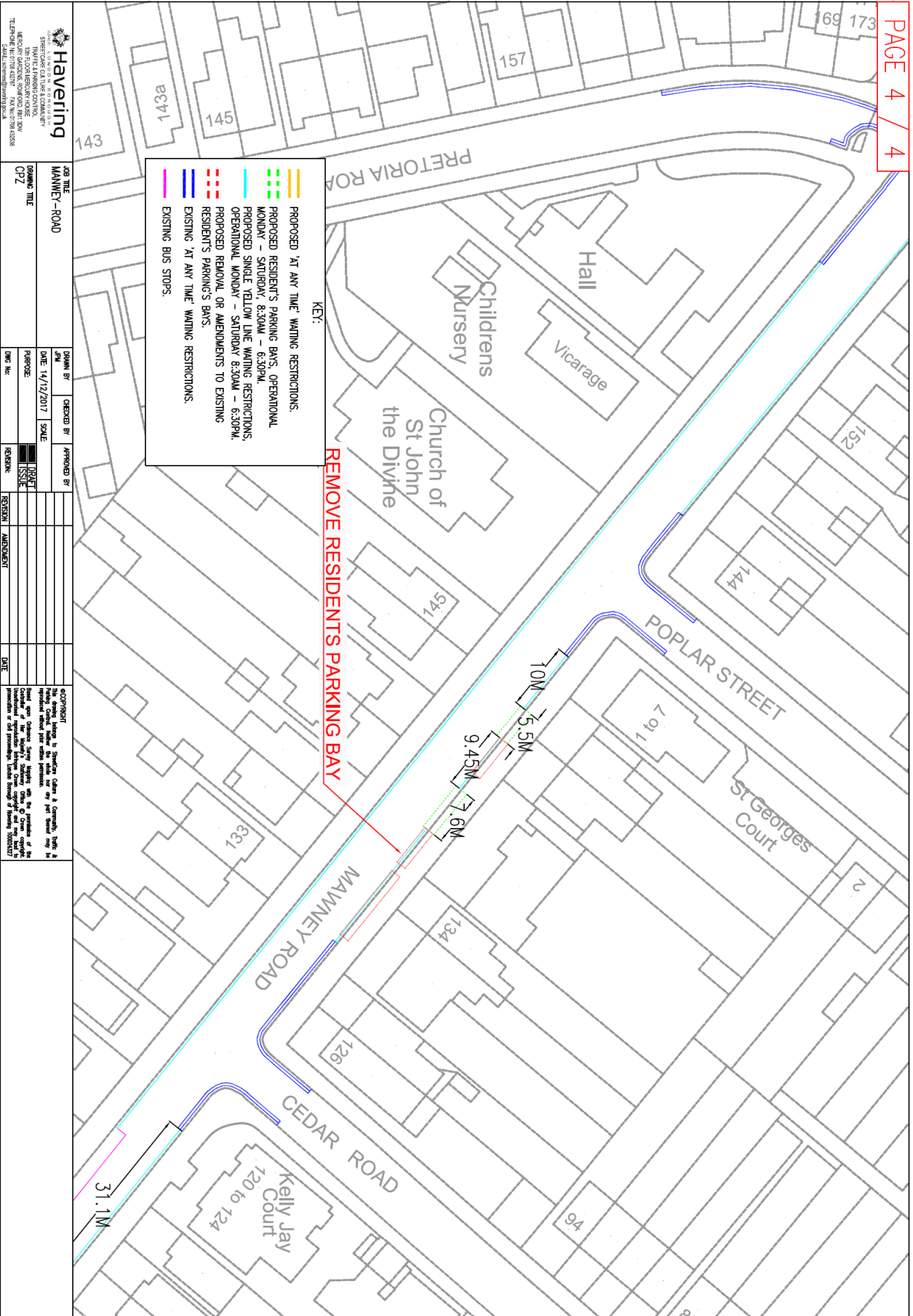

KEY:

- PROPOSED 'AT ANY TIME' WAITING RESTRICTIONS:
- PROPOSED RESIDENT'S PARKING BAYS, OPERATIONAL MONDAY – SATURDAY 8:30AM – 6:30PM.
- PROPOSED SINGLE YELLOW LINE WAITING RESTRICTIONS, OPERATIONAL MONDAY – SATURDAY 8:30AM – 6:30PM.
- PROPOSED REMOVAL OR AMENDMENTS TO EXISTING RESIDENT'S PARKING BAYS.
- EXISTING 'AT ANY TIME' WAITING RESTRICTIONS.
- EXISTING BUS STOPS.

<p>Haverling <small>CONSTRUCTION CONSULTANTS</small> TRAFFIC & PARKING CONSULTANTS 100, 101, 102, 103, 104, 105, 106, 107, 108, 109, 110, 111, 112, 113, 114, 115, 116, 117, 118, 119, 120, 121, 122, 123, 124, 125, 126, 127, 128, 129, 130, 131, 132, 133, 134, 135, 136, 137, 138, 139, 140, 141, 142, 143, 144, 145, 146, 147, 148, 149, 150, 151, 152, 153, 154, 155, 156, 157, 158, 159, 160, 161, 162, 163, 164, 165, 166, 167, 168, 169, 170, 171, 172, 173, 174, 175, 176, 177, 178, 179, 180, 181, 182, 183, 184, 185, 186, 187, 188, 189, 190, 191, 192, 193, 194, 195, 196, 197, 198, 199, 200, 201, 202, 203, 204, 205, 206, 207, 208, 209, 210, 211, 212, 213, 214, 215, 216, 217, 218, 219, 220, 221, 222, 223, 224, 225, 226, 227, 228, 229, 230, 231, 232, 233, 234, 235, 236, 237, 238, 239, 240, 241, 242, 243, 244, 245, 246, 247, 248, 249, 250, 251, 252, 253, 254, 255, 256, 257, 258, 259, 260, 261, 262, 263, 264, 265, 266, 267, 268, 269, 270, 271, 272, 273, 274, 275, 276, 277, 278, 279, 280, 281, 282, 283, 284, 285, 286, 287, 288, 289, 290, 291, 292, 293, 294, 295, 296, 297, 298, 299, 300, 301, 302, 303, 304, 305, 306, 307, 308, 309, 310, 311, 312, 313, 314, 315, 316, 317, 318, 319, 320, 321, 322, 323, 324, 325, 326, 327, 328, 329, 330, 331, 332, 333, 334, 335, 336, 337, 338, 339, 340, 341, 342, 343, 344, 345, 346, 347, 348, 349, 350, 351, 352, 353, 354, 355, 356, 357, 358, 359, 360, 361, 362, 363, 364, 365, 366, 367, 368, 369, 370, 371, 372, 373, 374, 375, 376, 377, 378, 379, 380, 381, 382, 383, 384, 385, 386, 387, 388, 389, 390, 391, 392, 393, 394, 395, 396, 397, 398, 399, 400, 401, 402, 403, 404, 405, 406, 407, 408, 409, 410, 411, 412, 413, 414, 415, 416, 417, 418, 419, 420, 421, 422, 423, 424, 425, 426, 427, 428, 429, 430, 431, 432, 433, 434, 435, 436, 437, 438, 439, 440, 441, 442, 443, 444, 445, 446, 447, 448, 449, 450, 451, 452, 453, 454, 455, 456, 457, 458, 459, 460, 461, 462, 463, 464, 465, 466, 467, 468, 469, 470, 471, 472, 473, 474, 475, 476, 477, 478, 479, 480, 481, 482, 483, 484, 485, 486, 487, 488, 489, 490, 491, 492, 493, 494, 495, 496, 497, 498, 499, 500, 501, 502, 503, 504, 505, 506, 507, 508, 509, 510, 511, 512, 513, 514, 515, 516, 517, 518, 519, 520, 521, 522, 523, 524, 525, 526, 527, 528, 529, 530, 531, 532, 533, 534, 535, 536, 537, 538, 539, 540, 541, 542, 543, 544, 545, 546, 547, 548, 549, 550, 551, 552, 553, 554, 555, 556, 557, 558, 559, 560, 561, 562, 563, 564, 565, 566, 567, 568, 569, 570, 571, 572, 573, 574, 575, 576, 577, 578, 579, 580, 581, 582, 583, 584, 585, 586, 587, 588, 589, 590, 591, 592, 593, 594, 595, 596, 597, 598, 599, 600, 601, 602, 603, 604, 605, 606, 607, 608, 609, 610, 611, 612, 613, 614, 615, 616, 617, 618, 619, 620, 621, 622, 623, 624, 625, 626, 627, 628, 629, 630, 631, 632, 633, 634, 635, 636, 637, 638, 639, 640, 641, 642, 643, 644, 645, 646, 647, 648, 649, 650, 651, 652, 653, 654, 655, 656, 657, 658, 659, 660, 661, 662, 663, 664, 665, 666, 667, 668, 669, 670, 671, 672, 673, 674, 675, 676, 677, 678, 679, 680, 681, 682, 683, 684, 685, 686, 687, 688, 689, 690, 691, 692, 693, 694, 695, 696, 697, 698, 699, 700, 701, 702, 703, 704, 705, 706, 707, 708, 709, 710, 711, 712, 713, 714, 715, 716, 717, 718, 719, 720, 721, 722, 723, 724, 725, 726, 727, 728, 729, 730, 731, 732, 733, 734, 735, 736, 737, 738, 739, 740, 741, 742, 743, 744, 745, 746, 747, 748, 749, 750, 751, 752, 753, 754, 755, 756, 757, 758, 759, 760, 761, 762, 763, 764, 765, 766, 767, 768, 769, 770, 771, 772, 773, 774, 775, 776, 777, 778, 779, 780, 781, 782, 783, 784, 785, 786, 787, 788, 789, 790, 791, 792, 793, 794, 795, 796, 797, 798, 799, 800, 801, 802, 803, 804, 805, 806, 807, 808, 809, 810, 811, 812, 813, 814, 815, 816, 817, 818, 819, 820, 821, 822, 823, 824, 825, 826, 827, 828, 829, 830, 831, 832, 833, 834, 835, 836, 837, 838, 839, 840, 841, 842, 843, 844, 845, 846, 847, 848, 849, 850, 851, 852, 853, 854, 855, 856, 857, 858, 859, 860, 861, 862, 863, 864, 865, 866, 867, 868, 869, 870, 871, 872, 873, 874, 875, 876, 877, 878, 879, 880, 881, 882, 883, 884, 885, 886, 887, 888, 889, 890, 891, 892, 893, 894, 895, 896, 897, 898, 899, 900, 901, 902, 903, 904, 905, 906, 907, 908, 909, 910, 911, 912, 913, 914, 915, 916, 917, 918, 919, 920, 921, 922, 923, 924, 925, 926, 927, 928, 929, 930, 931, 932, 933, 934, 935, 936, 937, 938, 939, 940, 941, 942, 943, 944, 945, 946, 947, 948, 949, 950, 951, 952, 953, 954, 955, 956, 957, 958, 959, 960, 961, 962, 963, 964, 965, 966, 967, 968, 969, 970, 971, 972, 973, 974, 975, 976, 977, 978, 979, 980, 981, 982, 983, 984, 985, 986, 987, 988, 989, 990, 991, 992, 993, 994, 995, 996, 997, 998, 999, 1000</p>	
JOB TITLE	MAINNEY ROAD
DRAWING TITLE	CP2
DATE	14/12/2017
SCALE	
DESIGNED BY	ROBERT
CHECKED BY	ROBERT
APPROVED BY	ROBERT
DATE	
REVISION	AMENDMENT
DATE	
<p>DISCLAIMER This drawing is prepared by the undersigned and is intended to be used for the purposes of the project described herein. It is not to be used for any other purpose without the written consent of the undersigned. The undersigned shall not be held responsible for any errors or omissions in this drawing or for any consequences arising from its use. The undersigned shall not be held responsible for any changes to the project or for any delays or costs incurred as a result of such changes.</p>	

Appendix B –

Respondent of address	Summary of Comments
Resident of Mawney Road:	Objection: Objecting to propose placing of a parking bay outside 112 Mawney Road. The resident has off street parking down the shared access next to 112 Mawney Road there is often heavy traffic along this stretch of road and it is necessary to be able to see when there is a gap in the traffic approaching to allow one to pull out safely.
Resident of Mawney Road:	General: However Marks Road is not part of the R02B zone and has different operating times under zone ROW. Does this mean that Marks Road will be returned to zone R02B as it was when residents parking was introduced? It would be the perfect time to do this and remove the anomaly for addresses such as mine that are in Mawney Road but have rear right of way to our properties from Marks Road. I park a vehicle in a resident's bay in Marks Road zone ROW which historically used to be in zone R02B. I have an annual problem renewing my residents permit as I cannot do it online and have to visit the PASC due to the zone conflict.
Resident of Oak Street:	Objection: I'm a little disappointed to hear that after complaints of faded bay lines and missing or incorrect signs are being resolved by adding a Saturday to the resident parking scheme. Which will result in residents having to buy more visitor permits especially as it's more likely that visitors will park on the road on a Saturday to visit friends and family? It's already a costly expense to park outside your own house and with the added extra permits being brought for visitors and now with the proposed Saturday parking too, it's another added cost and not associated with the initial problem addressed in the letter and only benefiting the council financially.
Resident of Mawney Road:	Objection: The original parking scheme dating back to 1997 is and always has been a Monday to Friday restriction with no restrictions on Saturdays. Please see attached a copy of a letter I received in 1997 outlining the restrictions which clearly shows the scheme is presently Monday to Friday. This has always worked well; we have never had any problems or issues of any kind with shoppers or commuters parking in Mawney road south of Eastern Avenue on a Saturday. Making the scheme Monday to Saturday would unnecessarily severely restrict parking for friends and family visiting on a Saturday as there is limited off road parking and in some cases could cause issues between neighbours with shared drives vying for space to park. Therefore, I object to your proposals and want the scheme to remain a Monday to Friday 8.30am to 6.30pm as it is currently.
Resident of Mawney Road:	Objection: Myself and my fellow neighbours have been discussing the proposal, and we feel it would not be

	<p>beneficial for this change to take place. We often have family and friends visit and so I would not want any added parking restrictions. To clarify we want to keep the original Monday- Friday restrictions and not to continue restrictions to include Saturday as well. Also I would like to mention I have not had any issues with members of the public who have no association to residents on Mawney road, parking on my road or in front of my drive.</p>
Resident of Mawney Road:	<p>We are writing to object to such a change. The restrictions are currently mainly Monday to Friday, which we believe stops commuters from parking along a main road all day, we have no objections to this as we are not only at work during the restricted times 8.30 am to 6.30 pm but believe as children use the pavements to walk to school, it deems it safer for them to have a clear path.</p> <p>However the restrictions being increased to a Saturday seems to only burden the residents. We do not have a drive and therefore would have two options both of which incur a cost we are not prepared to pay for.</p>
Resident of Mawney Road:	<p>I agree that the restrictions need to be rationalised because at present the parking bay markings are not clear and the information given on the notices are conflicting. I do however; oppose the decision to make the restrictions Monday-Saturday. I assume that originally the scheme was introduced to stop commuters parking but that is not a problem at the weekends and I therefore think the weekends should be free. As a resident of Mawney Road for 8 years, along with my husband and daughter, we have had to pay a lot of money to park our cars outside our house and allow visitors to do the same. To have a scheme where you also pay on Saturdays just increases our expense and is not beneficial to the residents.</p>
Resident of Mawney Road:	<p>I am not happy about the parking arrangements outside my house changing. This would be an inconvenience as we have family and friends visiting at the weekend and therefore we object to the proposed change.</p>
No address:	<p>We've lived in the road for 25+ years and as long as the restrictions have been in force they've only been Monday to Friday but the new rationalisation seems to be suggesting Monday to Saturday which wouldn't suit us at all as we have a very large family who mainly visit over the weekend and it would be difficult for them to do this if the parking restrictions were in force on a Saturday, also my daughter works from home on a Saturday and it would make it impossible for her to continue doing this as well.</p>